

# Wiseasy IoT Solution

A cloud-native platform built on WiseCloud, designed to unify devices, applications, and business systems into one intelligent ecosystem.

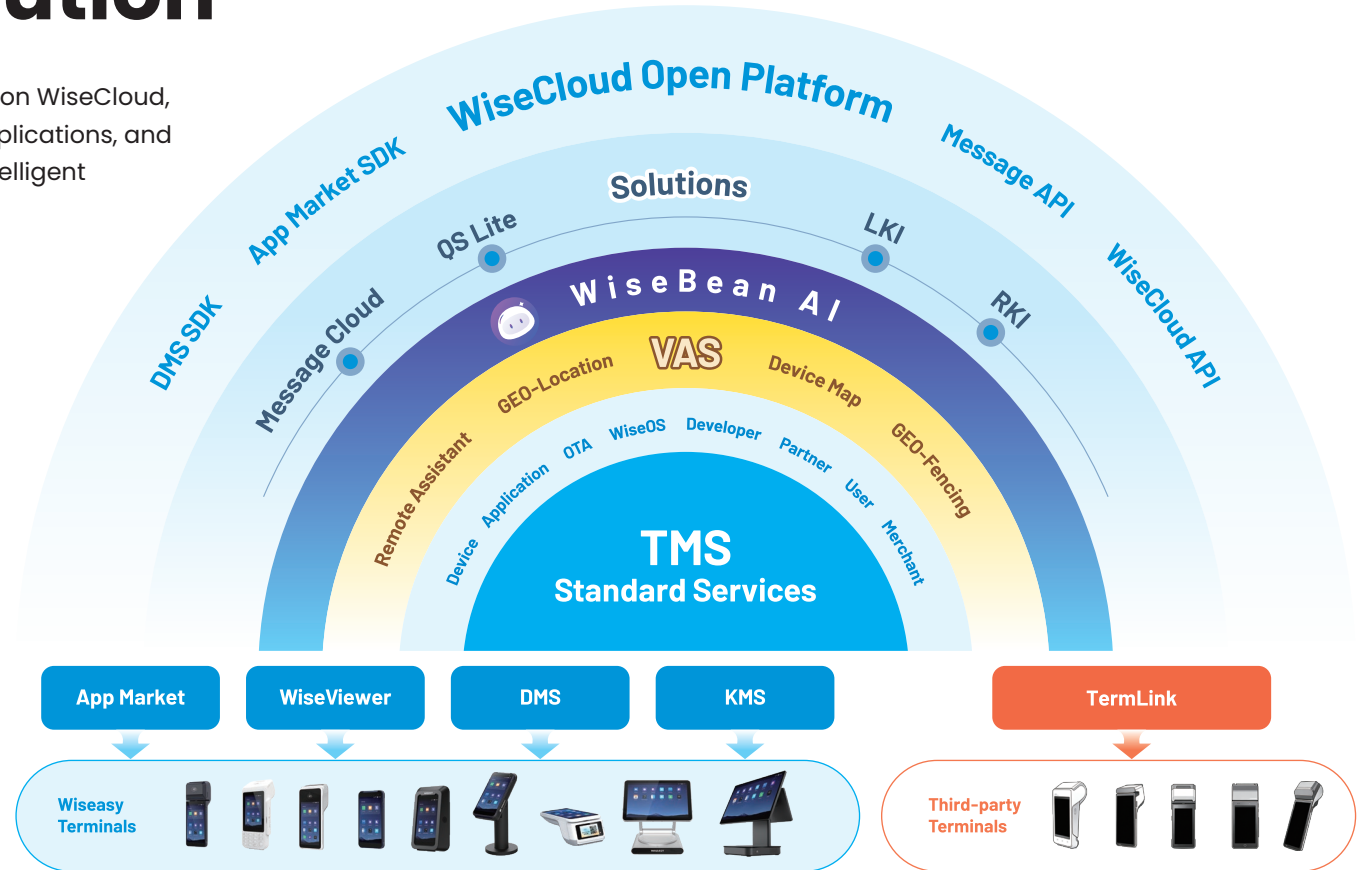

# WiseCloud

## A Unified Platform for End-to-End Control

At the core of the solution is WiseCloud, which acts as the command center for the entire lifecycle of your device fleet. Through a single interface, operators can remotely manage devices, deploy applications, and configure large fleets in real time.

The platform also supports Over-The-Air (OTA) updates, allowing software, configurations, and new features to be deployed instantly across devices without physical intervention. This reduces operational complexity, lowers costs, and ensures systems remain up to date.

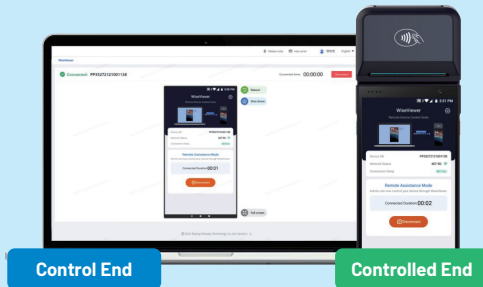

# WiseViewer

## Real-Time Support with WiseViewer

WiseViewer enables instant remote access to payment devices, allowing operators to diagnose and resolve issues in real time. This capability improves system uptime, enhances merchant satisfaction, and reduces the need for on-site servicing.

# WiseKey

## End-to-End Security with WiseKey

Security remains a critical priority in modern payment environments. WiseKey provides comprehensive key management, supporting both Remote Key Injection (RKI) and Local Key Injection (LKI). This ensures secure transactions while reducing manual effort and operational overhead.

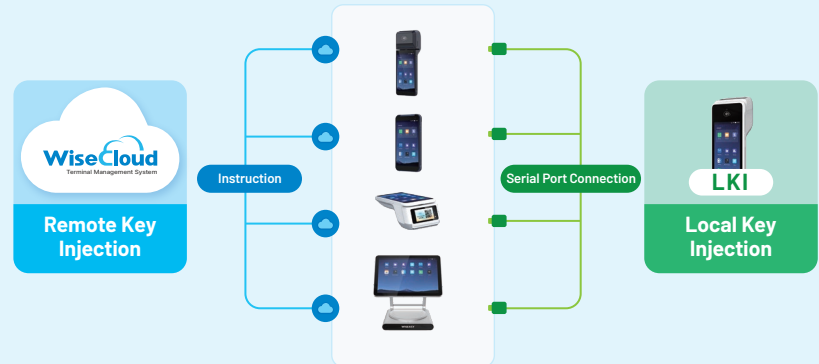

# TermLink

## Multi-Device Integration with Termlink

Wiseeasy's open integration framework, Termlink, enables seamless onboarding and management of multi-brand POS devices alongside Wiseeasy terminals. By eliminating the need for multiple systems, businesses can centralize operations and manage hybrid device fleets with greater efficiency.

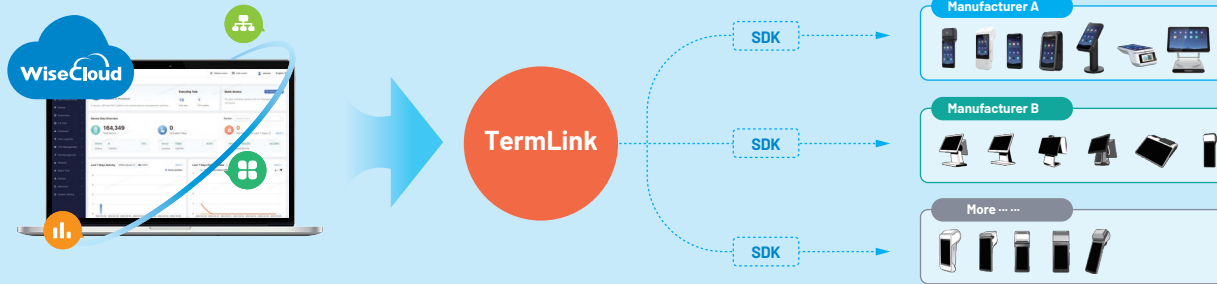

# WiseBean AI

## AI-Powered Operations with WiseBean

Embedded within WiseCloud, WiseBean introduces an AI-native conversational interface that transforms how teams interact with their terminal management system. Users can retrieve insights, execute commands, and resolve issues through natural language, enabling faster decision-making and improved productivity.

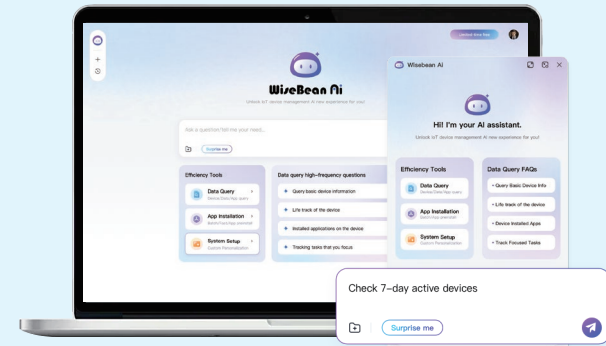

# An efficient, secure, and convenient IOT platform for you



## All-in-one Platform

WiseCloud is the unified command center for your entire operation, integrating device management with WiseViewer, WiseKey, and WiseBean into one seamless ecosystem. Operators gain real-time, comprehensive visibility and control—all built on a PCI DSS-certified foundation that delivers not only connectivity, but proven security and reliability.



## Data-driven Decisions & Insights

Data visualization is central to our IoT platform. It clearly presents both macro trends and granular device-level data, transforming raw information into actionable insights. This empowers operators to make informed, timely decisions that optimize efficiency and drive growth.



## AI-Driven Intelligent Evolution

The platform features a built-in, AI-native assistant that transforms traditional point-and-click menus into a natural language conversation. This shift enables the TMS to learn, adapt, and anticipate needs—moving from a static tool to a proactive, evolving partner for future-ready management.